

411UDAC Dress Panel Product Installation Drawing

Document #51130 Rev. A 1/8/99 ECN 98-582

The optional 411UDAC Dress Panel (required for Canadian applications) can be installed to prevent accidental contact with the AC wiring terminals and wiring connected to other terminals. To install the Dress Panel:

1. As a safety precaution, it is highly recommended that all power be removed from the main circuit board before proceeding with installation procedure.
2. Remove and save the four screws and attached washers which are used to secure the four corners of the main circuit board to the backbox mounting standoffs. Refer to Figure 1.
3. Install and tighten the four standoffs, which were supplied with the Dress panel, in the four corner holes which were just vacated in step 2. Note that the male threaded end is used to resecure the main circuit board to the backbox mounting standoffs. Refer to Figure 1.
4. Position the four holes in the Dress Panel over the four standoffs installed in step 3. Note that the notched edge of the Dress Panel must be positioned to the right in order to accommodate the lock mechanism. Refer to Figure 2.
5. Complete the installation by securing the Dress Panel with the four screws and attached washers which were removed in step 2. Refer to Figure 2.
6. If all other installation has been completed, reapply power to the main circuit board.

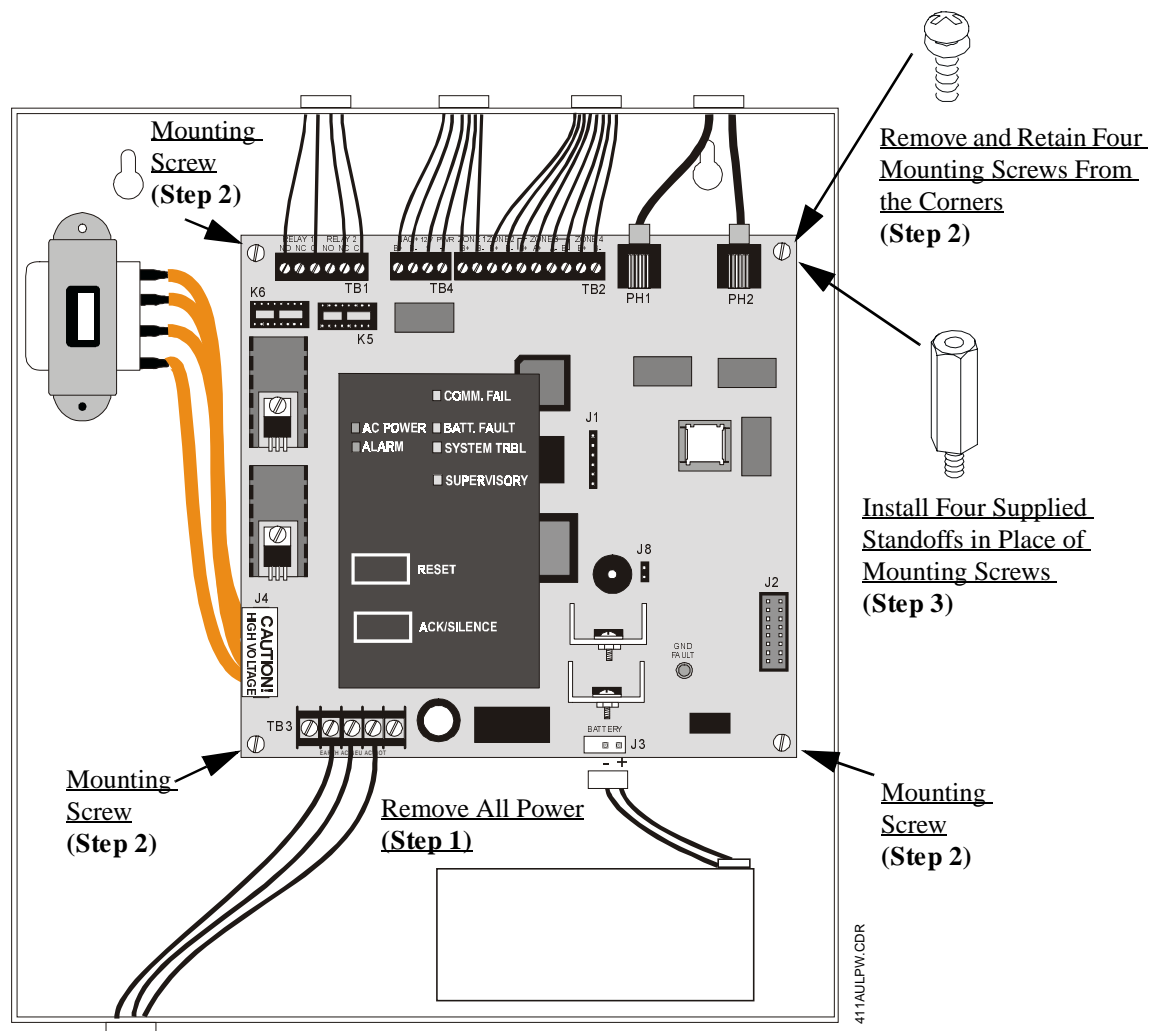

Figure 1: Mounting Screws

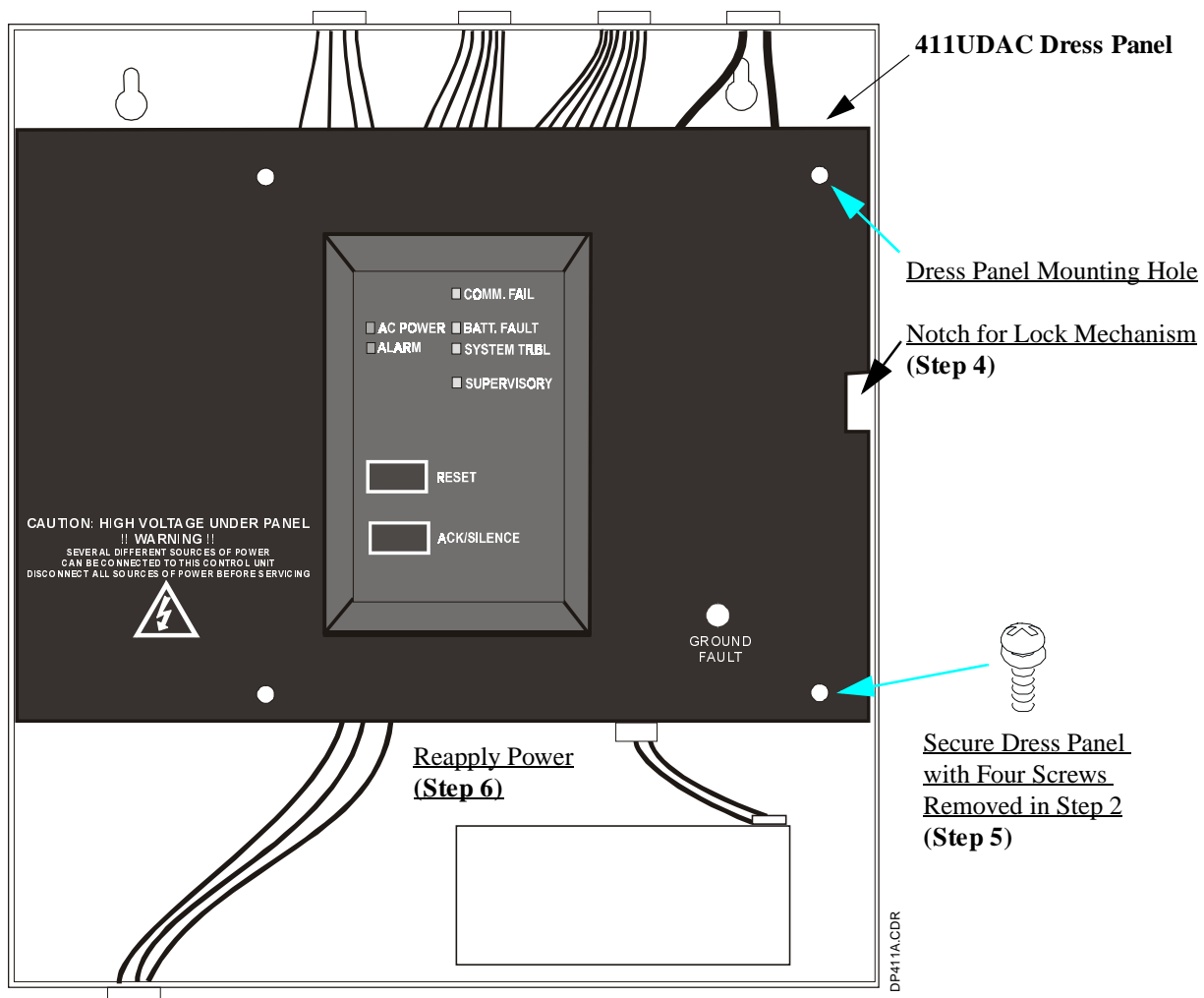

Figure 2: Dress Panel Installation